

## ТЕХНИЧЕСКА ХАРАКТЕРИСТИКА

**3040**



**3040**

PORTAGOMMA MASCHIO CONICO - MALE HOSE ADAPTER (TAPER)

**НИПЕЛ ЩУЦЕР - конусовиден**

**Характеристики:**

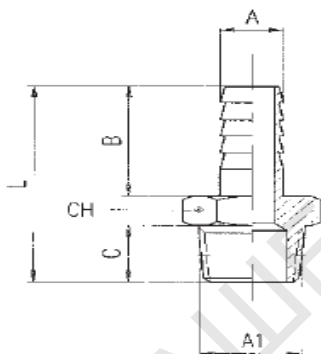

A	A1	B	C	L	CH	Conf. Pack.
6	- 1/8	19.5	7.5	32	12	50
6	- 1/4	19.5	11	35.5	14	50
7	- 1/8	19.5	7.5	32	12	50
7	- 1/4	19.5	11	35.5	14	50
8	- 1/8	19.5	7.5	32	12	50
8	- 1/4	19.5	11	35.5	14	50
9	- 1/8	19.5	7.5	32	12	50
9	- 1/4	19.5	11	35.5	14	50
9	- 3/8	19.5	11.5	36	17	25
9	- 1/2	19.5	14	39	22	25

**размери**

**бр.опаковка**

**виж стр. 2- за др.размери**

A	A1	B	C	L	CH	Conf. Pack.
10	- 1/8	19.5	7.5	32	12	50
10	- 1/4	19.5	11	35.5	14	50
10	- 3/8	19.5	11.5	36	17	25
10	- 1/2	19.5	14	39	22	25
12	- 1/4	19.5	11	35.5	14	50
12	- 3/8	19.5	11.5	36	17	25
12	- 1/2	19.5	14	39	22	25
14	- 3/8	19.5	11.5	36	17	25
14	- 1/2	19.5	14	39	22	25
16	- 3/8	19.5	11.5	36	17	25
16	- 1/2	19.5	14	39	22	25
16	- 3/4	19.5	16.5	43.5	27	25
17	- 3/8	19.5	11.5	36	18	25
17	- 1/2	19.5	14	39	22	25
18	- 3/8	19.5	11.5	36	19	25
18	- 1/2	19.5	14	39	22	25
18	- 3/4	19.5	16.5	43.5	27	25
20	- 3/8	19.5	11.5	36	21	25
20	- 1/2	19.5	14	39	22	25
20	- 3/4	19.5	13.5	40	27	25
25	- 3/4	19.5	14.5	41	27	25
25	- 1"	30	16	53.5	34	10